

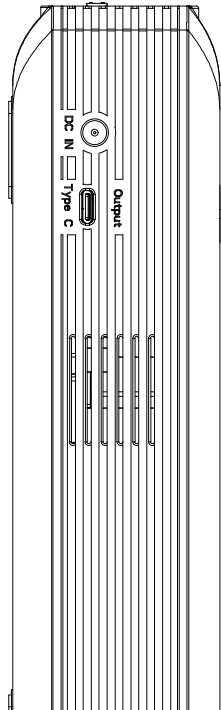

Win Free Products
charge.tech.com/vip

Follow the Journey
[@getcharge.tech online](https://twitter.com/getcharge.tech)

Get the App
charge.tech.com/app



WWW.CHARGETECH.COM



PLUG

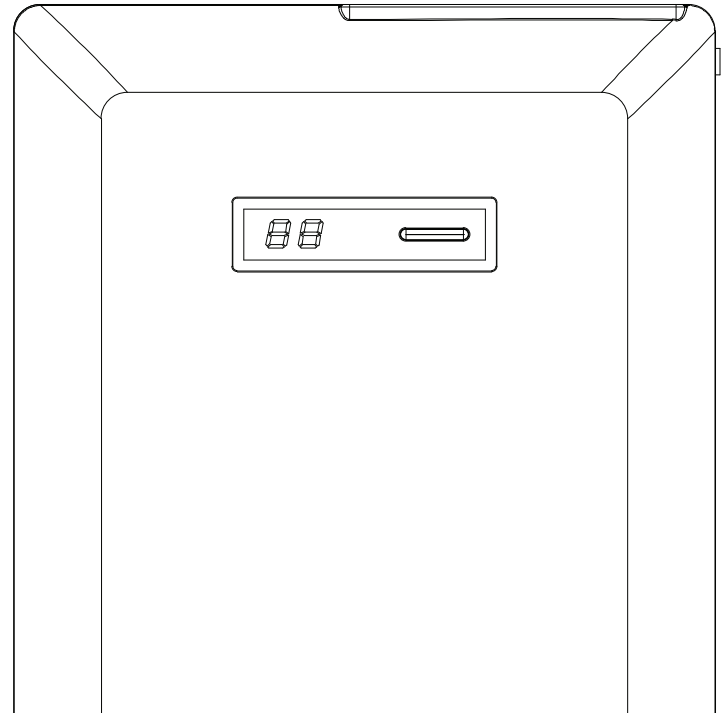

OWNER'S MANUAL

Warranty & Return

What Does This Warranty Cover?

This Limited Warranty is provided by ChargeTech and covers defects in workmanship and materials in your PLUG. This Warranty period lasts for 1 year from the date of order delivery to the original end user customer. You will be required to provide proof of purchase to make warranty claims.

How Do I Get Service ?

If your product requires troubleshooting or warranty service, visit the following link:
<https://goo.gl/h4gsXW>

Dated proof of purchase must accompany the product and the product must not have been disassembled or modified without prior written authorization by ChargeTech.

Warranty does not cover normal wear and tear of the product, and ChargeTech will not be responsible for any defect in or damage to the product if it has been misused, neglected, improperly installed, physically damaged or altered, either internally or externally, or damaged from improper use or being used in an unsuitable environment. If it has been subjected to fire, water, general corrosion, biological infestations, or input voltage that creates operating conditions beyond the maximum or minimum limits listed in the ChargeTech product specifications including high input voltage from generators and lightning strikes, the warranty claim may be denied and the claimant responsible for any return shipping charges.



Specifications

AC Power Output x 2

AC output voltage(nominal) : 120V AC
Continuous AC output Power : 250W
Peak AC output power: 300W
Maximum AC output surge power : 350W
Ac output frequency : 60Hz
Battery Capacity : 42,000mAh or 54,000mAh

USB Power Output x 2

DC output voltage : 5V DC
DC output Current(Max) : 3.4Amps

Type-C power Output x 1

DC output voltage : 5V DC
DC output Current(Max) : 3.1Amps

DC Power Specifications

DC input voltage : 20-24VDC
Battery drain with no load : <3mA
Efficiency (Maximum) : 85%
Low battery MCU shutdown point : 12.5V
Low battery PCM shutdown point : 12V
High battery MCU shutdown point : 17V
High battery PCM shutdown point : 17.4V
Temperature shutdown point : 65°C

What's Included In The Box

- 42,000mAh or 54,000mAh PLUG
- 43W Charging AC Adapter
- International AC Prong Adapter
- Carrying Pouch
- Owner's Manual

Warning & Conditions

- Keep children away from PLUG. It can generate the same potentially dangerous level of AC power as a normal household wall outlet.
- The PLUG unit may become uncomfortably warm, reaching 140°F (60°C) under extended high power usage. While you are using the PLUG, make sure to keep it away from materials that may be affected by high temperatures.
- Do not use the PLUG in the presence of flammable fumes or gases, such as near fireplaces or propane tanks.
- Use caution when inserting an AC plug into the three-prong AC outlet. The prongs of an AC plug can become bent from misuse, if an AC plug is improperly inserted the AC outlet, a bent prong can slip outside of PLUG and become a shock hazard.
- Hold on to PLUG carefully when inserting or removing an AC plug. Keep your fingers clear of the AC outlet. Ensure that your fingers do not come in contact with the prongs of the AC plug if it is partially inside PLUG.
- Some chargers made from small nickel-cadmium batteries can be damaged if connected to PLUG. Do not use the PLUG with devices that request a pure wave power source.
- Do not connect any AC load that has its neutral conductor connected to ground with PLUG.

Additional Safety Guidelines

- Do not insert foreign objects in PLUG's AC outlet or other openings.
- Never connect PLUG to power utility AC distribution wiring.
- Do not use PLUG in temperatures over 100°F (40°C).
- Do not expose PLUG to water, rain, snow or spray.
- Failure to follow these safety guideline may cause personal injury and/or damage to PLUG. It may also void your product warranty.

Interference With Electronic Equipment

Generally, most AC products receive power from PLUG as they would from a regular household AC outlet. The following information is concerning two possible exceptions:

Trouble shooting

Measured AC Power Outlet Output Is To Low

Possible Cause :

Standard “ average reading “AC voltmeter used to measure output voltage, voltage, resulting in an apparent reading 5 to 15V too low.

Possible Remedy:

PLUG is “modified sine wave” and output requires “ true RMS” voltmeter for accurate measurements.

Trouble shooting

PLUG will not Operate, None of the Display/Lights Turn On.

Possible Cause 1:

Battery is defective. Overload protection.

Possible Remedies :

- **Option 1 :** Fully recharge PLUG.
- **Option 2 :** Let PLUG run out of the battery completely by recharging only small devices(cell phone) through the USB port. Once PLUG is out of battery, recharge the unit to full capacity again to reset the unit.
- **Option 3 :** Request a replacement unit through the warranty policy.

Possible Cause 2 :

PLUG has overheated due to poor ventilation and has shut down.

Possible Remedies :

Reduce load if continuous operation is required.

Possible Cause 3:

The battery voltage is too low.

Possible Remedies :

- **Option 1 :** Fully recharge PLUG.
- **Option 2 :** Let PLUG run out of the battery completely by recharging only small devices(cell phone) through the USB port. Once PLUG is out of battery, recharge the unit to full capacity again to reset the unit.

Possible Cause 4:

Using it with motor products

Possible Remedies :

Motor products with high surge voltage and need wave output. It is strongly recommended that you do not use PLUG with these devices.

Possible Cause 5:

High starting surge has caused overload shutdown.

Possible Remedies :

Battery is on low power or product exceeds PLUG's starting surge capability

Buzzing Sound In Audio Systems and Radios

Some inexpensive stereo systems and AM-FM radios have inadequate internal power supply filtering and "buzz" slightly when powered by PLUG. Generally, the only solution is an audio product with a higher quality filter.

Television Interference

PLUG is shielded to minimize its interference with TV signals. However, The weak TV signals interference may be visible in the form of lines scrolling across the screen. The following should minimize or eliminate the problem:

- Increase the distance between PLUG, the television, and antenna and cables.
- Adjust the orientation of PLUG, television, an antenna and cables.
- Maximize TV signal strength by using a better antenna and shielded antenna cable where possible.

Safety Features

These advanced safety features are built into PLUG.

- Electric overload protection with automatic shutdown.
- High/Low input voltage protection with automatic shutdown
- Overheat protection with automatic shutdown
- Output short circuit protection
- Standby timer off
- Overcharge protection with maximum voltage limited
- Charging timer/temperature protection.

Failure to follow these safety guidelines may cause personal injury and/or damage to the Portable Power Outlet. It may also void your product warranty.

Battery Operating Time

Operating time will vary depending on the charge level of the battery, its capacity and the power level drawn by the particular device being charged. For example: devices that requires 160W of power of power, an operating of 1 to 1.5 hours or more can be expected.

Device Features

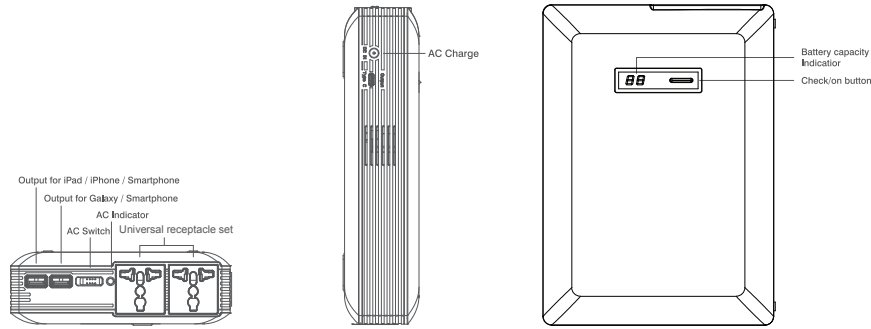

PLUG Functions

PLUG is able to charge 120VAC devices that require 15-250 watts of power. PLUG's USB ports can also power most electronic devices that draw power from a USB source. PLUG's AC output waveform is "modified sine wave", and is designed to function similarly to the sine wave shape of utility power.

How to Charge PLUG

Use the included 43W Charging Adapter to recharge the PLUG. Insert the AC plug of the Charging Adapter into a regular wall outlet, avoiding any power strings or extension cords, if possible. Connect the circular barrel plug DC jack of the Charging Adapter into PLUG. The unit should automatically begin charging and showing a flashing digital display. When the unit is fully charged, PLUG will display will show "FF" for 7-8 hours before use.

How to Operate PLUG

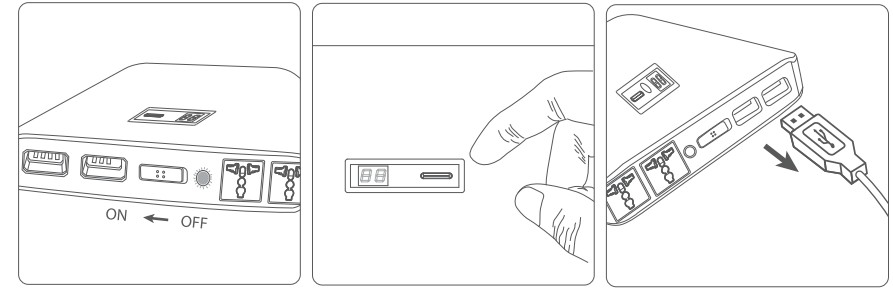

- To use the AC outlet option: slide the AC power switch to the ON position and press the silver power indicator button located on the top of the unit. The solid red LED light will come on, which indicates that the AC outlet is on. The AC outlet will begin powering when you plug a device into the socket.
- The device must be 15-250W for the AC outlet to work. If the device is less 5W or more than 250W, the AC outlet will auto-shut off. The red LED light will turn off.
- Make sure you slide the AC power switch to the OFF position when not in use.
- The USB output will automatically power off after about 90 seconds if there is no device detected. To maximize the amount of power output from the USB ports, make sure the AC power switch is in the OFF position.
- PLUG will automatically power off if no device is detected after 90 seconds.
- To manually power off PLUG: press and hold down the power button (located on the top of the unit) for 3 seconds. All LED lights/display should turn off.
- Warning: if PLUG exceeds a safe operating temperature, due to insufficient ventilation or a high-temperature environment, the unit will automatically shutdown. The red LED light will turn off.
- At 200W of power, an operating time of 1 to 1.5 hours or more can be expected.