

|    |                          |                                                                                                                                                                                  |
|----|--------------------------|----------------------------------------------------------------------------------------------------------------------------------------------------------------------------------|
| 15 | Cooling fan              | 2PC fan                                                                                                                                                                          |
| 16 | AC power cord            | 1PC                                                                                                                                                                              |
| 17 | Manual                   | 1PC                                                                                                                                                                              |
| 18 | Carton Package Dimension | <input type="checkbox"/> 20 Bay- 25.20IN*17.72IN*29.33IN<br><input type="checkbox"/> 30 Bay- 25.20IN*18.90IN*39.37IN<br><input type="checkbox"/> 40 Bay- 25.20IN*18.90IN*49.02IN |
| 19 | Net weight               | <input type="checkbox"/> 20 Bay-68.34LBS<br><input type="checkbox"/> 30 Bay-95.57LBS<br><input type="checkbox"/> 40 Bay- 114.64LBS                                               |
| 20 | Gross weight             | <input type="checkbox"/> 20 Bay-81.79LBS<br><input type="checkbox"/> 30 Bay-114.86LBS<br><input type="checkbox"/> 40 Bay- 145.95LBS                                              |

Product specifications and configurations are for reference only. Subject to change without notice.

### ChargeTech LLC

Add: 260 Newport Center Drive Newport Beach, CA 92660

Te l : 888-250-8756

Web: ChargeTech.com



# Charging Cabinet

User manual

Model: Clean & Charge USB Cabinet



## Note before use

Please carefully read the following before using and installing this product. You need to strictly check the whole cabinet and each compartment to ensure everything is intact. Use the following steps to ensure proper power connection.

1. Please make sure of socket type ( FIG.1 )

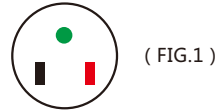

2. Please make sure the socket can be earthed.

If you cannot ensure this situation, please check with an AVO meter. When socket has a ground connection, there must be no voltage between PE and N, and PE and L must have L110V ( FIG.2 )

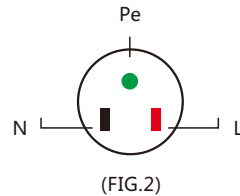

3. Please do not use in the following environments. Please place in a suitable space and apply brake to the two front wheels. This will secure the cabinet from moving forward/back.



Slope



High temperature



Damp



Avoid sun and rain

4. Please do not place near any window, as you need to avoid sun and rain. This will maximize the product safety and lifetime.

## Maintenance instructions

For first-time use or if product has not been used for a long time, please follow these steps:

- When moving the cabinet, please release the brake from the two front wheels (using hand pull-up brake); avoid damaging the wheels.
- When cleaning, do not pour water, alcohol, or cleaner into the cabinet; avoid wetting the power board, as it will affect use and safety.
- If you want to discontinue use for a long period of time, please pull the power plug from the socket and put package in a transparent bag, which will protect its working life.
- When doing repairs, do not work on the unit with it plugged in. An expert must repair the cabinet, and the power cable must be unplugged.

Due to the continuous improvement of our structures appearance, the products you purchase may differ from the appearance structure without prior notice.

## Operating instructions

- Please remove the AC power cable from the small box, connect the power connection port first. Then insert the plug into the socket.
- Please open the side door with the triangle key; turn on the blue switch on RCCB.
- Please connect charging cable with tablet charging port and the cabinet's USB port. Doing this, it will charge when the unit is powered on.
- When you turn on the green button, the UV lamp will automatically turn on within 5 minutes to do a disinfection cycle. After those 5 minutes, the cabinet will auto charge within 10 hours.

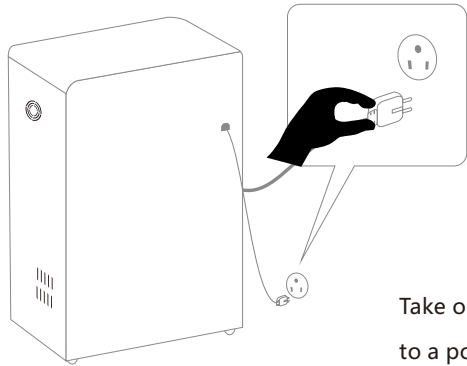

**1**

Take out AC power cord and connect to a power outlet.

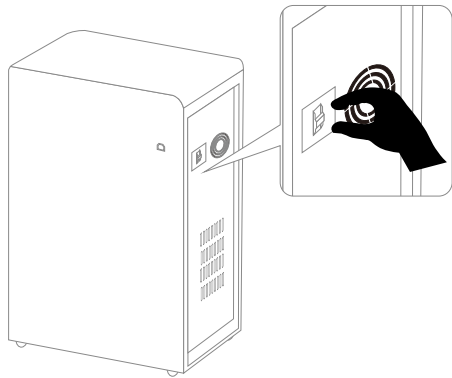

**2**

Open side door with triangle key , turn on RCCB then close the door.

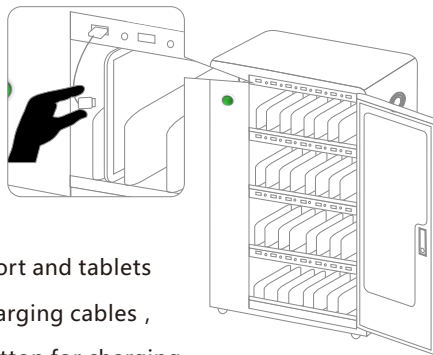

**3**

Please connect USB port and tablets charging port with charging cables , then turn on green button for charging.

## Charging Cabinet Technical Parameters and Configuration

| No. | Items                           | Content                                                                                                                                                                       |                                                                    |
|-----|---------------------------------|-------------------------------------------------------------------------------------------------------------------------------------------------------------------------------|--------------------------------------------------------------------|
| 1   | Product model                   | 20/30/40 Bay Clean & Charge USB Cabinet                                                                                                                                       |                                                                    |
| 2   | Color                           | Black                                                                                                                                                                         |                                                                    |
| 3   | Appearance size                 | <input type="checkbox"/> 20 Bay-21.89IN*14.57IN*26.18IN<br><input type="checkbox"/> 30 Bay-21.89IN*15.75IN*36.22IN<br><input type="checkbox"/> 40 Bay-21.89IN*15.75IN*46.85IN |                                                                    |
| 4   | Input voltage                   | 110VAC                                                                                                                                                                        |                                                                    |
| 5   | Input frequency                 | 47-63HZ                                                                                                                                                                       |                                                                    |
| 6   | Total output power              | <input type="checkbox"/> 20 Bay-280W<br><input type="checkbox"/> 30 Bay-400W<br><input type="checkbox"/> 40 Bay-500W                                                          |                                                                    |
| 7   | Output voltage                  | 4.75-5.5V                                                                                                                                                                     |                                                                    |
| 8   | Output current                  | 1-2.38A                                                                                                                                                                       |                                                                    |
| 9   | Output current limit protection | 42A-60A                                                                                                                                                                       |                                                                    |
| 10  | Protect                         | Over voltage                                                                                                                                                                  | Hiccup mode, the load exception condition is removed automatically |
| 11  |                                 | Over heat                                                                                                                                                                     |                                                                    |
| 12  | RCCB                            | 1PC Action electricity 0.03A $t \leq 0.1s$                                                                                                                                    |                                                                    |
| 13  | Handle                          | <input type="checkbox"/> 20 Bay-2pcs<br><input type="checkbox"/> 30 Bay-2pcs<br><input type="checkbox"/> 40 Bay-1pcs                                                          |                                                                    |
| 14  | UV lamp                         | <input type="checkbox"/> 20 Bay-4pcs<br><input type="checkbox"/> 30 Bay-6pcs<br><input type="checkbox"/> 40 Bay-8pcs                                                          |                                                                    |